

STATISTICS	# BR	GROSS AREA
GROUP HOME	4 B.R.	2,994 S.F.
UNIT A	1 B.R.	734 S.F.
UNIT B	2 B.R.	1,282 S.F.
TOTAL B.R.	7	
COMMUNITY ROOM UTILITY/STAIRS		345 S.F. 575 S.F.
TOTAL AREA		5,930 S.F.

PARKING			
GROUP HOME:	EMPLOYEES	2	
	VISITORS	2	
SUPPORTIVE APARTMENTS:	RESIDENTS	1	
	VISITORS	2	
ACCESSIBLE SPACES:		1	
TOTAL		8	

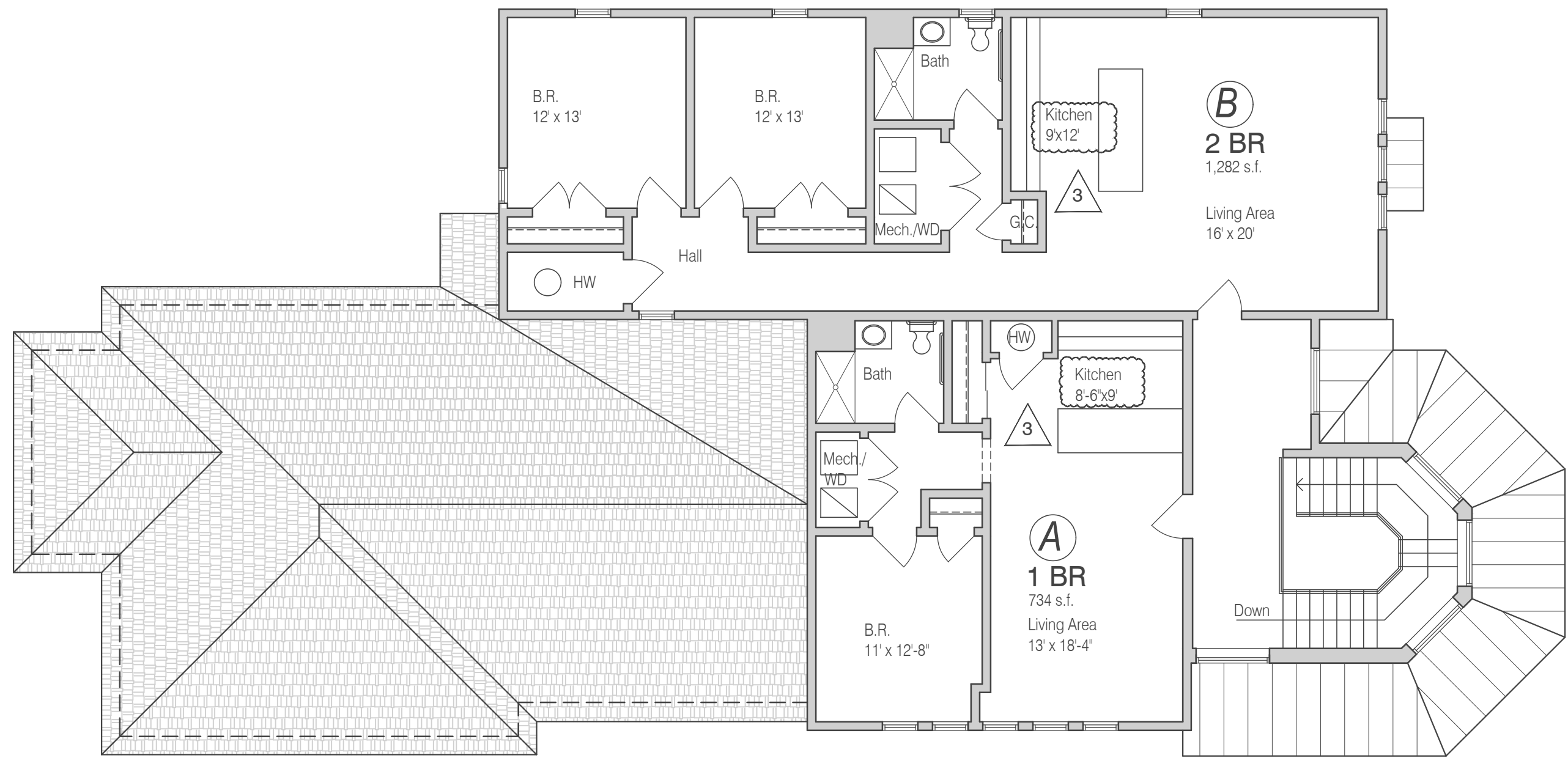

1 | Ground Floor Plan
[1/8" = 1'-0"]

2 | Second Floor Plan
[1/8" = 1'-0"]

ORADELL SUPPORTIVE HOUSING

Proposed Group Home and Supportive Housing Units

Genther Avenue | Oradell, New Jersey

Bergen County United Way/Madeline Corp. NFP Partnership
Forest Avenue
Paramus, NJ

Developer

This drawing is the property of Virgona & Virgona Architects. Any unauthorized use or reproduction of this drawing without the written consent of the Architect will be prosecuted to the fullest extent allowed under all applicable copyright laws.

2/22/24: REVISED PER ZONING BOARD COMMENTS
2/15/24: REVISED PARKING TO MATCH SITE PLAN
11/10/23: AREAS OF UNITS A/B COINCIDE WITH CHART

Revisions

Consultants

VIRGONA + VIRGONA

ARCHITECTS | PLANNERS

125 RIVER ROAD SUITE 201 | EDGEWATER, NEW JERSEY 07020



Drawn: J.V.
Checked: [initials]
Date: 10 OCTOBER 2023
Scale: AS NOTED
Job No: [blank]

Contents
PLANS/STATISTICS
Dwg No: [blank]